

Fittings with short Spigot

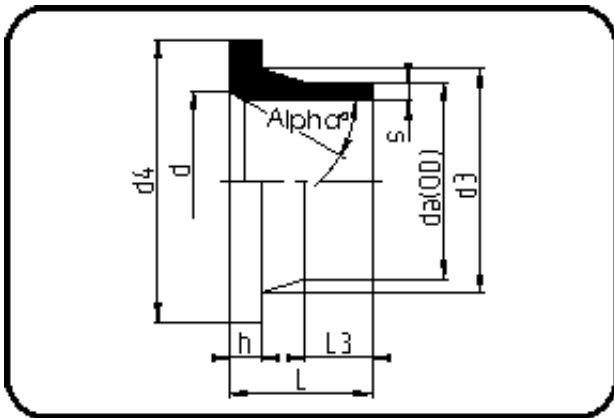

Code: 012.7

- Chamfered Stub Flange ANSI
- for butterfly valves
- injection moulded+chamfered
- **Butt-welding**
- PPR grey

Backing Rings please see Accessories.

Dimension	Code	Detail	Weight
400	11.012.7400.11	400X36,3 SDR11 ISO S-5	8.58

	Unit	Nominale	Tol+	Tol-
da(OD)	mm	400	3.60	0.00
L	mm	155	4.00	2.00
L3	mm	70	2.00	0.00
s	mm	36,3	3.80	0.00
d	mm	378	3.00	0.00
alph	[°]	30	0.00	3.00
d3	mm	427	0.00	5.00
h	mm	46	1.50	2.25
d4	mm	482	0.00	1.00