

Fittings

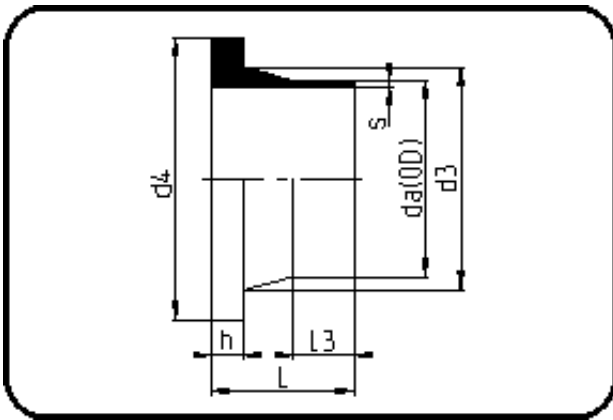

Code: 012

- Stub Flange DIN
- short spigot
- injection moulded
- **Butt + IR + HPF-welding**
- PVDF natural

Backing Rings please see Accessories.

Dimension	Code	Detail	Weight
40	30.012.0040.21	40X2,4 SDR21 ISO S-10	0.09

	Unit	Nominale	Tol+	Tol-
da(OD)	mm	40	0.40	0.00
L	mm	50	3.75	0.00
L3	mm	24	1.50	0.00
s	mm	2,4	0.50	0.00
d3	mm	50	0.00	3.00
h	mm	8	0.75	0.00
d4	mm	78	0.00	1.50