

## Valves

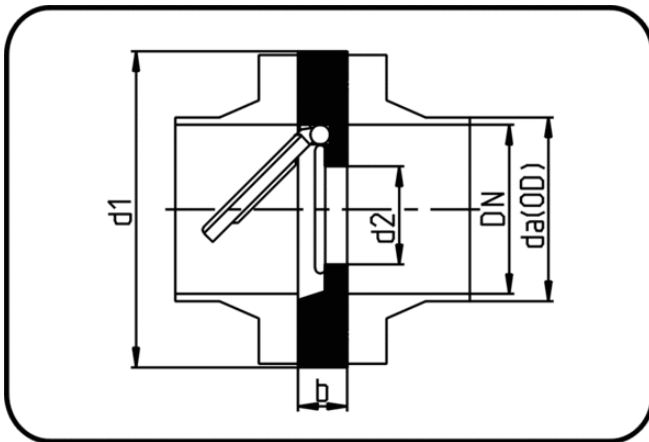

Code: 339.13

- **Swing Type Check Valve w/o Sp.**
- FPM-sealing S4
- injection moulded
- **Flange connection DIN**
- **PP Pure grey**

An outlet support is necessary for these articles.

Dimension	Code	Detail	da(OD) mm	d1 mm	d2 mm	b mm	DN mm	Weight
40	72.339.1340.11	40 - MOP 6 bar	40	85	18	15	32	0.22
50	72.339.1350.11	50 - MOP 6 bar	50	96	22	16	40	0.25
63	72.339.1363.11	63 - MOP 6 bar	63	108,5	32	20	50	0.36
140	72.339.1314.11	140 - MOP 6 bar	140	194	91	22	125	0.52
315	72.339.1331.11	315 - MOP 6 bar	315	397	213	45	300	3.60