

Fittings

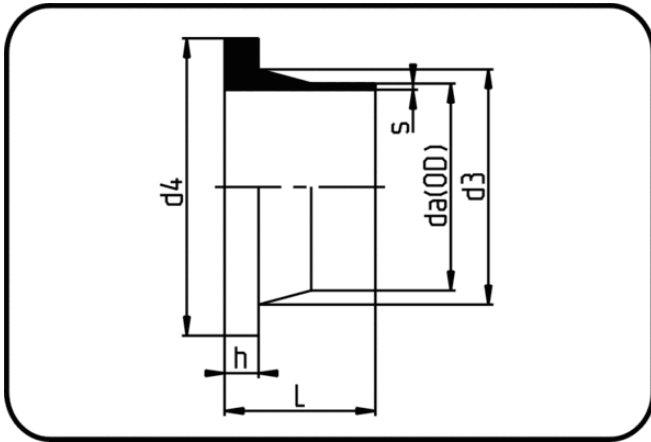

Code: 012

- **Stub Flange DIN**
- short spigot
- injection moulded
- **Butt + IR-welding**
- **ECTFE natural**

Backing Rings please see Accessories.

Dimension	Code	Detail	da(OD) mm	s mm	L mm	d3 mm	d4 mm	h mm	Weight
20	40.012.0020.21	20X1,9 SDR21 ISO S-10	20	1,9	49	27	45	6	0.03
25	40.012.0025.21	25X1,9 SDR21 ISO S-10	25	1,9	50	33	58	6,5	0.04
32	40.012.0032.21	32X2,4 SDR21 ISO S-10	32	2,4	50	40	68	7	0.04
40	40.012.0040.21	40X2,4 SDR21 ISO S-10	40	2,4	50	50	78	8	0.09
50	40.012.0050.21	50X3,0 SDR21 ISO S-10	50	3	50	61	88	9	0.12
63	40.012.0063.21	63X3,0 SDR21 ISO S-10	63	3	50	76	102	10	0.17
75	40.012.0075.21	75X3,6 SDR21 ISO S-10	75	3,6	50	89	122	10	0.23
90	40.012.0090.21	90X4,3 SDR21 ISO S-10	90	4,3	80	105	138	11	0.38
110	40.012.0110.21	110X5,3 SDR21 ISO S-10	110	5,3	80	125	158	12	0.52
140	40.012.0140.21	140X6,7 SDR21 ISO S-10	140	6,7	80	155	188	15	0.72
160	40.012.0160.21	160X7,7 SDR21 ISO S-10	160	7,7	81	175	212	16	1.02