

Fittings

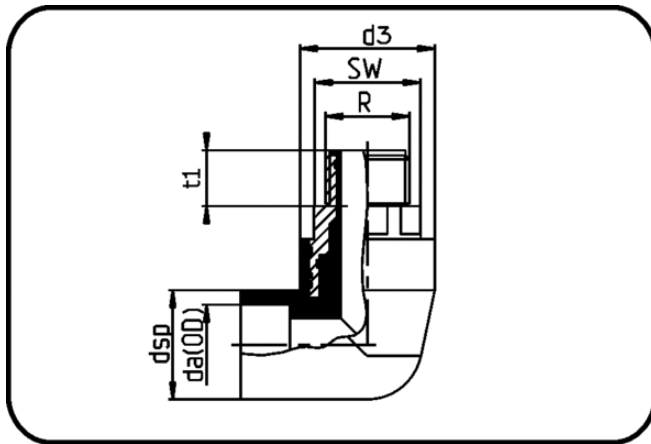

Code: 22.086

- **Transition Elbow 90°**
- with R metal male thread
- injection moulded
- **Socket-welding**
- **PE 100 blue**

Dimension	Code	Detail	da(OD) mm	t1 mm	d3 mm	SW mm	R inch	dsp mm	Weight
20	22.086.2020.07	20X1/2" - MOP 16 bar	20	16	38	32	0,5	30	0.13