

Fittings

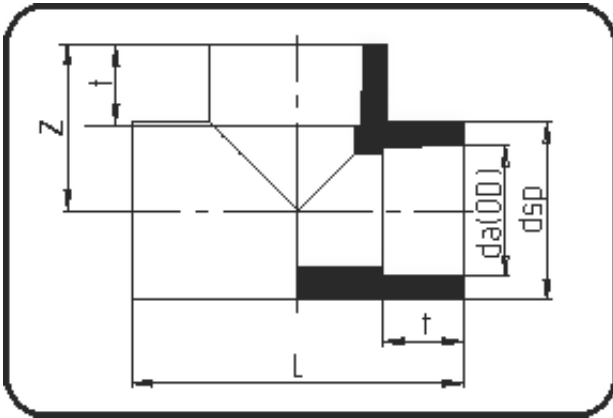

Code: 056

- Tee
- injection moulded
- **Socket-welding**
- PE 100 blue

Dimension	Code	Detail	Weight
110	22.056.0110.07	110 - MOP 16 bar	1.12

	Unit	Nominale	Tol+	Tol-
da(OD)	mm	110	0.00	0.00
L	mm	206	3.00	3.00
dsp	mm	134,5	1.50	1.50
t	mm	43	1.50	1.50
p	bar	16	0.00	0.00
z	mm	101,5	1.00	1.00