

Fittings

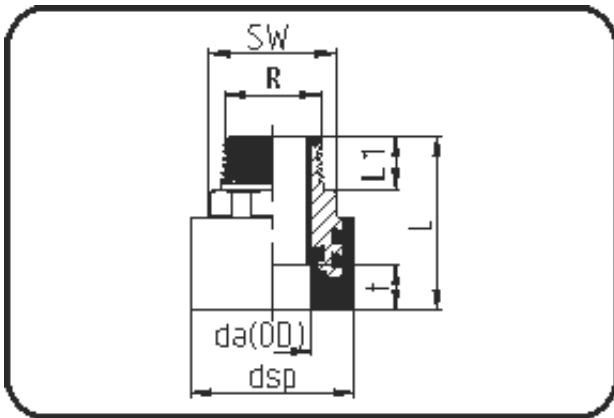

Code: 22.083.20

- **Adaptor**
- R metal male thread+hexag.
- injection moulded
- **Socket-welding**
- **PE 100 blue**

Dimension	Code	Detail	Weight
32	22.083.3232.07	32X1" - MOP 16 bar	0.27

	Unit	Nominale	Tol+	Tol-
da(OD)	mm	32	0.00	0.00
L	mm	75,5	0.75	0.75
L1	mm	22	0.75	0.75
SW	mm	39	0.00	0.00
dsp	mm	43	0.75	0.75
R	inch	1	0.00	0.00
t	mm	20	0.75	0.75
E	mm	33,25	0.00	0.00
p	bar	16	0.00	0.00
K	mm	30,29	0.00	0.00
da	inch	1	0.00	0.00