

PPR Poly-Flo

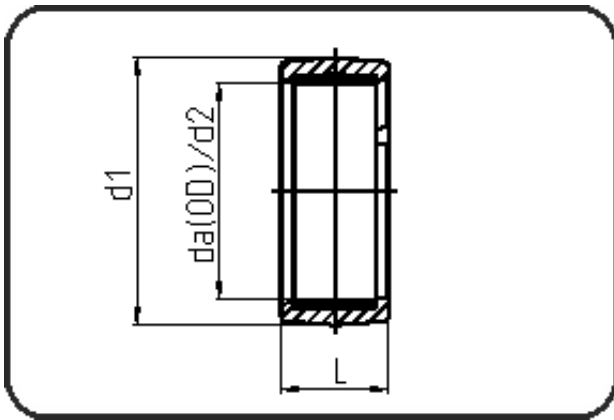

Code: 199

- Poly-Flo Induction E-Coupler

- injection moulded
- Induction welding
- PPR grey

Welding machine please see Welding Technology.

Dimension	Code	Detail	Weight
160	11.199.0160.17	160 SDR17	0.34

	Unit	Nominale	Tol+	Tol-
da(OD)	mm	160	0.00	0.00
L	mm	50	1.00	1.00
d1	mm	185	0.20	0.20