

Fittings with short Spigot

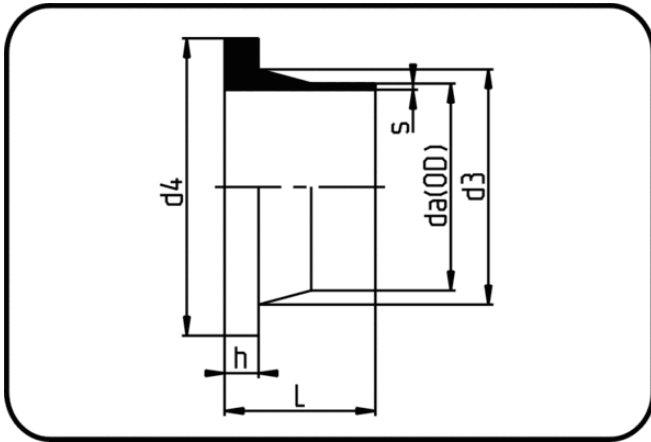

Code: 012

- **Stub Flange DIN**
- short spigot
- flame retardant
- injection moulded
- **Butt-welding**
- **PPs grey**

Dim. 90 - 160 SDR 11 Discontinued products. Backing Rings please see Accessories.

Dimension	Code	Detail	da(OD) mm	s mm	L mm	d3 mm	d4 mm	h mm	Weight
110	17.012.0110.33	110X3,4 SDR33 ISO S-16	110	3,4	80	125	158	18	0.28
160	17.012.0160.33	160X4,9 SDR33 ISO S-16	160	4,9	80	175	212	18	0.52
180	17.012.0180.33	180X5,5 SDR33 ISO S-16	180	5,5	95	183	212	18	0.42
200	17.012.0200.33	200X6,2 SDR33 ISO S-16	200	6,2	113	232	268	18	1.12
225	17.012.0225.33	225X6,9 SDR33 ISO S-16	225	6,9	113	235	268	18	0.86
250	17.012.0250.33	250X7,7 SDR33 ISO S-16	250	7,7	132	285	320	20	1.78
280	17.012.0280.33	280X8,6 SDR33 ISO S-16	280	8,6	128	288	320	20	1.20
315	17.012.0315.33	315X9,7 SDR33 ISO S-16	315	9,7	136	335	370	20	2.16
355	17.012.0355.33	355X10,9 SDR33 ISO S-16	355	10,9	150	373	430	23	2.98
400	17.012.0400.33	400X12,3 SDR33 ISO S-16	400	12,3	155	427	482	26	4.18
500	17.012.0500.33	500X15,3 SDR33 ISO S-16	500	15,3	120	530	585	33	7.11
20	17.012.0020.11	20X1,9 SDR11 ISO S-5	20	1,9	52	27	45	7	0.02
25	17.012.0025.11	25X2,3 SDR11 ISO S-5	25	2,3	52	33	58	9	0.03
32	17.012.0032.11	32X2,9 SDR11 ISO S-5	32	2,9	50	40	68	10	0.04
40	17.012.0040.11	40X3,7 SDR11 ISO S-5	40	3,7	52	50	78	11	0.06
50	17.012.0050.11	50X4,6 SDR11 ISO S-5	50	4,6	53	61	88	12	0.08
63	17.012.0063.11	63X5,8 SDR11 ISO S-5	63	5,8	50	75	102	14	0.13
75	17.012.0075.11	75X6,8 SDR11 ISO S-5	75	6,8	50,5	89	122	16	0.19
90	17.012.0090.11	90X8,2 SDR11 ISO S-5	90	8,2	82	105	138	17	0.32
110	17.012.0110.11	110X10,0 SDR11 ISO S-5	110	10	82	125	158	18	0.46
140	17.012.0140.11	140X12,7 SDR11 ISO S-5	140	12,7	92	155	188	25	0.70
160	17.012.0160.11	160X14,6 SDR11 ISO S-5	160	14,6	92	175	212	25	0.91