

Fittings

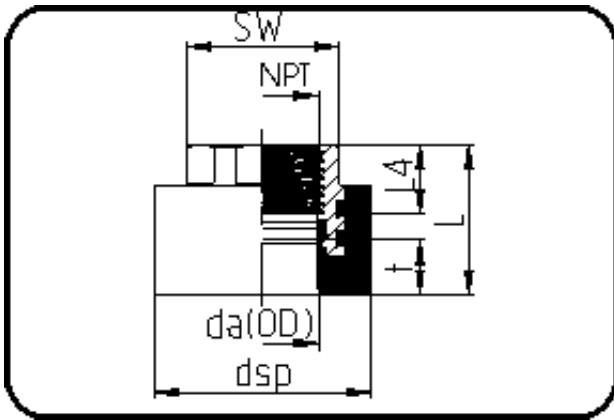

Code: 22.082.1

- Adaptor
- NPT metal female thread+hexag.
- injection moulded
- **Socket-welding**
- **PE 100 blue**

Dimension	Code	Detail	Weight
20	22.082.2021.07	20X1/2" - MOP 16 bar	0.14

	Unit	Nominale	Tol+	Tol-
da(OD)	mm	20	0.00	0.00
L	mm	41	0.75	0.75
NPT	inch	0,5	0.00	0.00
nr	ril	1,45	0.00	0.00
SW	mm	32	0.00	0.00
L4	mm	14	0.50	0.50
dsp	mm	42	0.75	0.75
t	mm	14,5	1.50	0.00
E	mm	8,13	0.00	0.00
p	bar	16	0.00	0.00
K	mm	19,26	0.00	0.00
da	inch	0,5	0.00	0.00