

PPR Poly-Flo

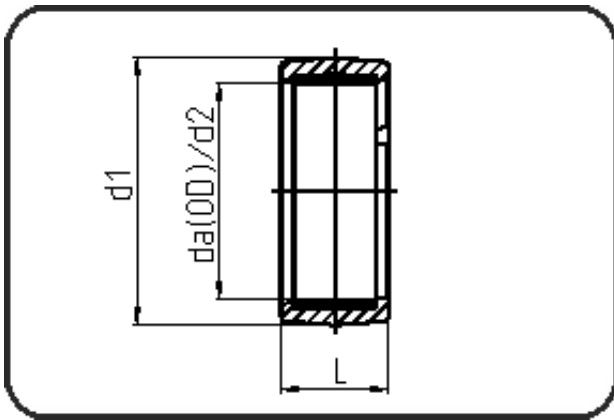

Code: 199

- Poly-Flo Induction E-Coupler

- injection moulded
- Induction welding
- PPR grey

Welding machine please see Welding Technology.

Dimension	Code	Detail	Weight
50	11.199.0050.17	50 SDR17	0.03

	Unit	Nominale	Tol+	Tol-
da(OD)	mm	50	0.00	0.00
L	mm	25	0.50	0.50
d1	mm	62,5	0.20	0.20