

Fittings for Socket Welding

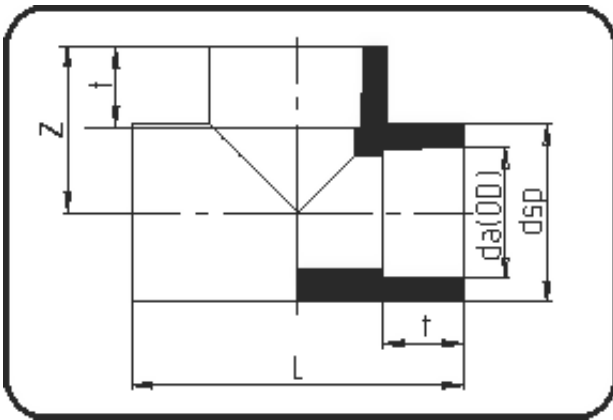

Code: 056

- Tee
- injection moulded
- **Socket-welding**
- **PPR grey**

Dimension	Code	Detail	Weight
32	11.056.0032.07	32 - MOP 20 bar	0.07

	Unit	Nominale	Tol+	Tol-
da(OD)	mm	32	0.00	0.00
L	mm	80	0.75	0.75
dsp	mm	43	0.75	0.75
t	mm	20	0.75	0.75
p	bar	20	0.00	0.00
z	mm	40	0.50	0.50