

Fittings for Socket Welding

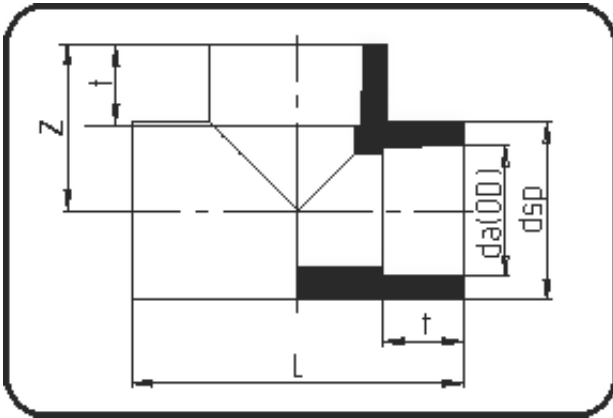

Code: 056

- Tee
- injection moulded
- **Socket-welding**
- PVDF natural

Dimension	Code	Detail	Weight
32	30.056.0032.07	32 - MOP 20 bar	0.13

	Unit	Nominale	Tol+	Tol-
da(OD)	mm	32	0.00	0.00
L	mm	80	3.00	3.00
dsp	mm	43	1.50	1.50
t	mm	19,5	0.75	0.75
p	bar	20	0.00	0.00
z	mm	40	1.00	1.00