

## Fittings for Socket Welding

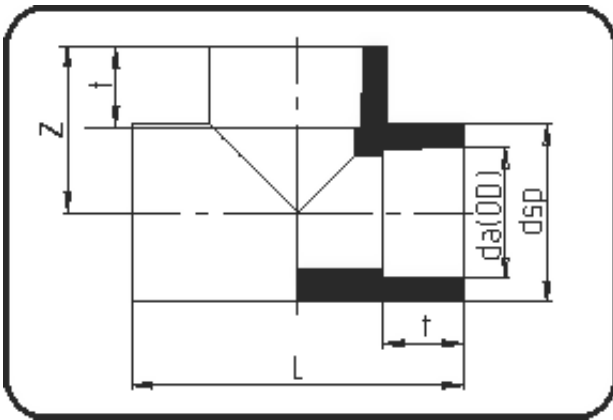

Code: 056

- Tee
- injection moulded
- **Socket-welding**
- PVDF natural

Dimension	Code	Detail	Weight
110	30.056.0110.07	110 - MOP 20 bar	1.98

	Unit	Nominale	Tol+	Tol-
da(OD)	mm	110	0.00	0.00
L	mm	208	3.00	3.00
dsp	mm	133	1.50	1.50
t	mm	43,5	0.75	0.75
p	bar	20	0.00	0.00
z	mm	100	1.00	1.00