

## Fittings with short Spigot

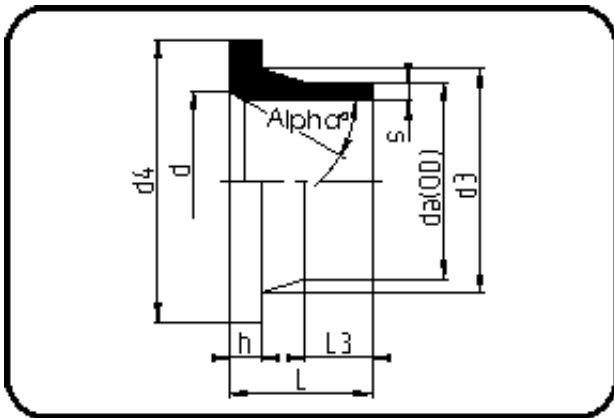

Code: 012.7

- Chamfered Stub Flange ANSI
- for butterfly valves
- injection moulded+chamfered
- **Butt-welding**
- PPR grey

Backing Rings please see Accessories.

| Dimension | Code           | Detail                 | Weight |
|-----------|----------------|------------------------|--------|
| 225       | 11.012.7225.11 | 225X20,5 SDR11 ISO S-5 | 1.81   |

|        | Unit | Nominale | Tol+ | Tol- |
|--------|------|----------|------|------|
| da(OD) | mm   | 225      | 2.10 | 0.00 |
| L      | mm   | 113      | 3.00 | 2.00 |
| L3     | mm   | 52       | 1.00 | 0.00 |
| s      | mm   | 20,5     | 2.20 | 0.00 |
| d      | mm   | 210      | 3.00 | 0.00 |
| alph   | [°]  | 30       | 0.00 | 3.00 |
| d3     | mm   | 235      | 0.00 | 4.00 |
| h      | mm   | 32       | 1.50 | 2.25 |
| d4     | mm   | 268      | 0.00 | 1.00 |