

Fittings for Socket Welding

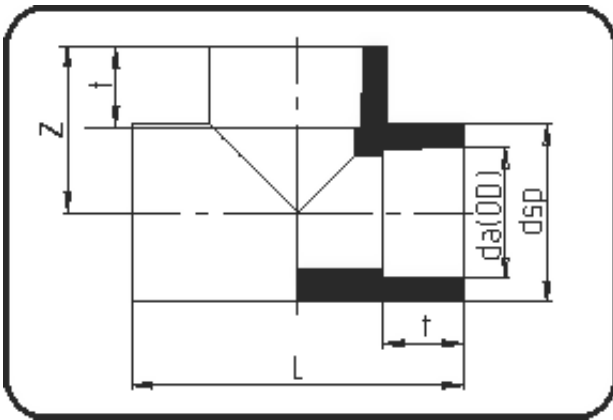

Code: 056

- Tee
- injection moulded
- **Socket-welding**
- PPR grey

Dimension	Code	Detail	Weight
40	11.056.0040.07	40 - MOP 20 bar	0.11

	Unit	Nominale	Tol+	Tol-
da(OD)	mm	40	0.00	0.00
L	mm	92	0.75	0.75
dsp	mm	53	0.75	0.75
t	mm	22	0.75	0.75
p	bar	20	0.00	0.00
z	mm	46	0.50	0.50