

## Fittings for Socket Welding

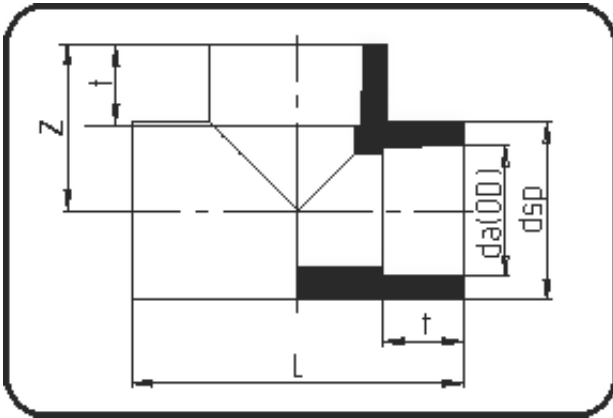

Code: 056

- Tee
- injection moulded
- **Socket-welding**
- **PPR grey**

Dimension	Code	Detail	Weight
25	11.056.0025.07	25 - MOP 20 bar	0.04

	Unit	Nominale	Tol+	Tol-
da(OD)	mm	25	0.00	0.00
L	mm	70	0.75	0.75
dsp	mm	35,2	0.75	0.75
t	mm	18	0.75	0.75
p	bar	20	0.00	0.00
z	mm	35	0.50	0.50