

## Fittings

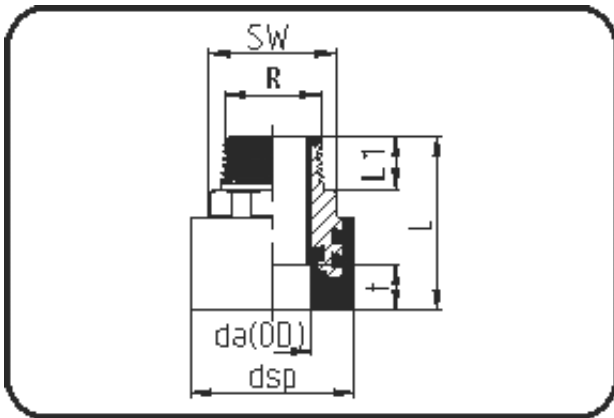

Code: 22.083.20

- **Adaptor**
- R metal male thread+hexag.
- injection moulded
- **Socket-welding**
- **PE 100 blue**

Dimension	Code	Detail	Weight
50	22.083.5050.07	50X1 1/2" - MOP 16 bar	0.65

	Unit	Nominale	Tol+	Tol-
da(OD)	mm	50	0.00	0.00
L	mm	77	0.75	0.75
L1	mm	27	0.75	0.75
SW	mm	60	0.00	0.00
dsp	mm	76	0.75	0.75
R	inch	1,5	0.00	0.00
t	mm	24	0.75	0.75
E	mm	47,80	0.00	0.00
p	bar	16	0.00	0.00
K	mm	44,85	0.00	0.00
da	inch	1,5	0.00	0.00