

Fittings

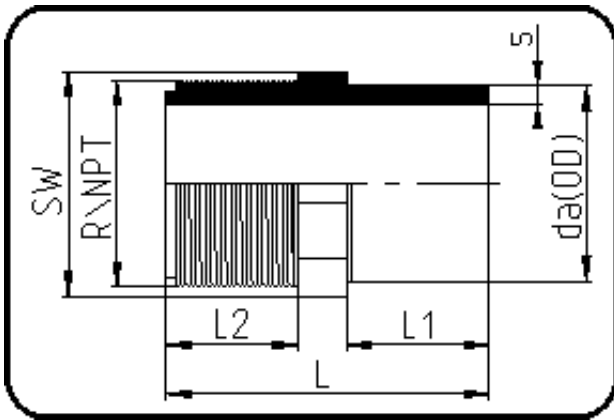

Code: 033

- Adapter Aussengewinde
- R-Gewinde
- formgespritzt
- **Stumpf+IR-Schweissung**
- **PP Pure grau**

Dimension	Code	Detail	Gewicht
25	72.033.2525.11	25X3/4" SDR11 ISO S-5	0.01

	Einheit	Nominale	Tol+	Tol-
da(OD)	mm	25	0.30	0.00
L	mm	51	3.00	3.00
L1	mm	22,5	1.50	1.50
SW	mm	27	2.25	2.25
L2	mm	20	1.50	1.50
s	mm	2,3	0.50	0.00
R	inch	0,75	0.00	0.00
E	mm	26,44	0.00	0.00
K	mm	24,12	0.00	0.00