

## Fittings

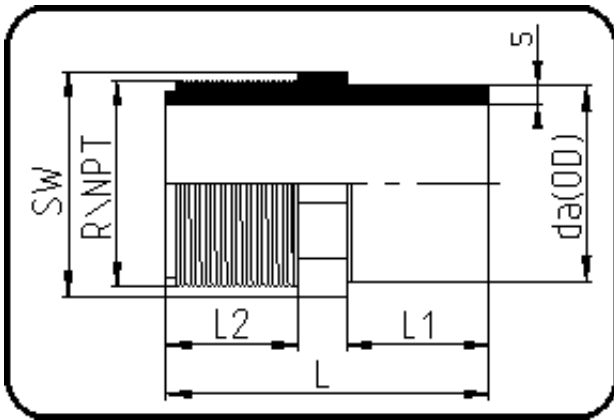

Code: 033

- Adapter Aussengewinde
- R-Gewinde
- formgespritzt
- **Stumpf+IR+HPF-Schweissung**
- PVDF UHP natur

Dimension	Code	Detail	Gewicht
63	35.033.6363.21	63X2" SDR21 MOP 10 bar	0.13

	Einheit	Nominale	Tol+	Tol-
da(OD)	mm	63	0.40	0.00
L	mm	80	3.00	3.00
L1	mm	35	1.50	1.50
SW	mm	65	2.25	2.25
L2	mm	31	1.50	1.50
s	mm	3	0.60	0.00
R	inch	2	0.00	0.00
E	mm	59,61	0.00	0.00
K	mm	56,66	0.00	0.00