

## Fittings

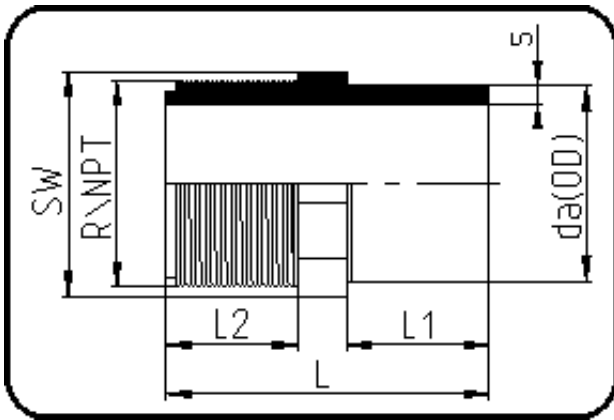

Code: 033

- Adapter Aussengewinde
- R-Gewinde
- formgespritzt
- **Stumpf+IR+HPF-Schweissung**
- PVDF UHP natur

| Dimension | Code           | Detail                 | Gewicht |
|-----------|----------------|------------------------|---------|
| 32        | 35.033.3232.21 | 32X1" SDR21 MOP 10 bar | 0.04    |

|        | Einheit | Nominale | Tol+ | Tol- |
|--------|---------|----------|------|------|
| da(OD) | mm      | 32       | 0.30 | 0.00 |
| L      | mm      | 61       | 3.00 | 3.00 |
| L1     | mm      | 29       | 1.50 | 1.50 |
| SW     | mm      | 36       | 2.25 | 2.25 |
| L2     | mm      | 23       | 1.50 | 1.50 |
| s      | mm      | 2,4      | 0.50 | 0.00 |
| R      | inch    | 1        | 0.00 | 0.00 |
| E      | mm      | 33,25    | 0.00 | 0.00 |
| K      | mm      | 30,29    | 0.00 | 0.00 |