

Fittings

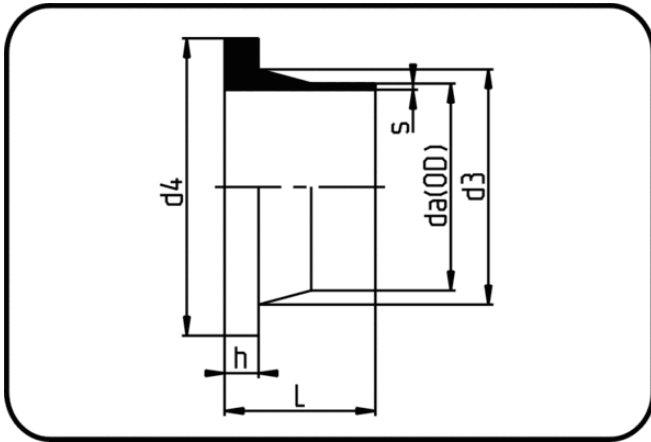

Code: 012

- **Vorschweissbund DIN**
- kurze Schenkel
- formgespritzt
- **Stumpf+IR-Schweissung**
- **PP Pure grau**

Flansche finden Sie bitte unter Zubehör.

| Dimension | Code | Detail | da(OD) mm | s mm | L mm | d3 mm | d4 mm | h mm | Gewicht |
|-----------|----------------|------------------------|--------------|---------|---------|----------|----------|---------|---------|
| 20 | 72.012.0020.11 | 20X1,9 SDR11 ISO S-5 | 20 | 1,9 | 52 | 27 | 45 | 7 | 0.02 |
| 25 | 72.012.0025.11 | 25X2,3 SDR11 ISO S-5 | 25 | 2,3 | 52 | 33 | 58 | 9 | 0.03 |
| 32 | 72.012.0032.11 | 32X2,9 SDR11 ISO S-5 | 32 | 2,9 | 50 | 40 | 68 | 10 | 0.04 |
| 40 | 72.012.0040.11 | 40X3,7 SDR11 ISO S-5 | 40 | 3,7 | 52 | 50 | 78 | 11 | 0.06 |
| 50 | 72.012.0050.11 | 50X4,6 SDR11 ISO S-5 | 50 | 4,6 | 53 | 61 | 88 | 12 | 0.09 |
| 63 | 72.012.0063.11 | 63X5,8 SDR11 ISO S-5 | 63 | 5,8 | 50 | 75 | 102 | 14 | 0.12 |
| 75 | 72.012.0075.11 | 75X6,8 SDR11 ISO S-5 | 75 | 6,8 | 50,5 | 89 | 122 | 16 | 0.19 |
| 90 | 72.012.0090.11 | 90X8,2 SDR11 ISO S-5 | 90 | 8,2 | 82 | 105 | 138 | 17 | 0.33 |
| 110 | 72.012.0110.11 | 110X10,0 SDR11 ISO S-5 | 110 | 10 | 82 | 125 | 158 | 18 | 0.44 |
| 125 | 72.012.0125.11 | 125X11,4 SDR11 ISO S-5 | 125 | 11,4 | 80 | 132 | 158 | 25 | 0.49 |
| 140 | 72.012.0140.11 | 140X12,7 SDR11 ISO S-5 | 140 | 12,7 | 92 | 155 | 188 | 25 | 0.71 |
| 160 | 72.012.0160.11 | 160X14,6 SDR11 ISO S-5 | 160 | 14,6 | 92 | 175 | 212 | 25 | 0.97 |
| 180 | 72.012.0180.11 | 180X16,4 SDR11 ISO S-5 | 180 | 16,4 | 93 | 183 | 212 | 30 | 0.99 |
| 200 | 72.012.0200.11 | 200X18,2 SDR11 ISO S-5 | 200 | 18,2 | 114 | 232 | 268 | 32 | 2.14 |
| 225 | 72.012.0225.11 | 225X20,5 SDR11 ISO S-5 | 225 | 20,5 | 113 | 235 | 268 | 32 | 2.03 |
| 250 | 72.012.0250.11 | 250X22,7 SDR11 ISO S-5 | 250 | 22,7 | 130 | 285 | 320 | 35 | 3.40 |
| 280 | 72.012.0280.11 | 280X25,4 SDR11 ISO S-5 | 280 | 25,4 | 128 | 288 | 320 | 35 | 3.11 |
| 315 | 72.012.0315.11 | 315X28,6 SDR11 ISO S-5 | 315 | 28,6 | 136 | 335 | 370 | 35 | 4.58 |