

## Fittings

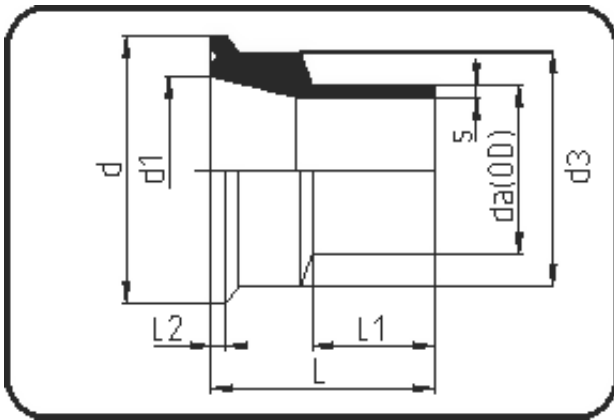

Code: 35.306

- Klemmverbinder
- mechanisch gefertigt
- **Stumpf+IR-Schweissung**
- PVDF UHP natur

DA 25+63 ISO 1127, DA 20,32,40,50 ISO 2852. Als Dichtungsmaterial empfehlen wir nur EPDM, FPM oder EPDM/PTFE.

| Dimension | Code           | Detail                  | Gewicht |
|-----------|----------------|-------------------------|---------|
| 50        | 35.306.0050.21 | 50X3,0 SDR21 MOP 10 bar | 0.06    |

|        | Einheit | Nominale | Tol+ | Tol- |
|--------|---------|----------|------|------|
| da(OD) | mm      | 50       | 0.00 | 0.00 |
| L      | mm      | 42       | 0.75 | 0.75 |
| L1     | mm      | 23       | 0.75 | 0.75 |
| L2     | mm      | 2,8      | 0.15 | 0.00 |
| s      | mm      | 3        | 0.00 | 0.00 |
| d      | mm      | 64       | 0.15 | 0.15 |
| d1     | mm      | 44,2     | 0.00 | 0.08 |
| d3     | mm      | 50       | 0.60 | 0.00 |
| da     | inch    | 1,5      | 0.00 | 0.00 |