

Fittings

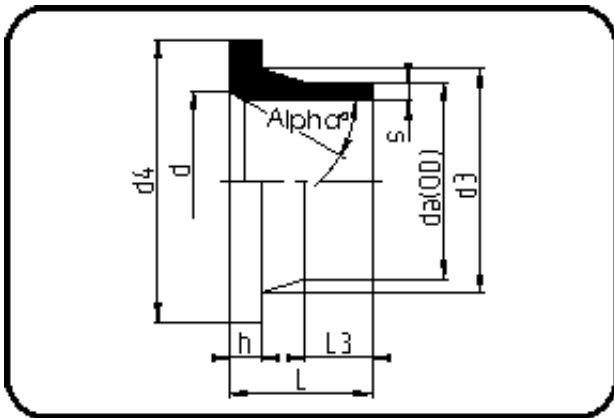

Code: 012.9

- Armaturenband DIN
- für Absperrklappen
- formgespritzt+ausgedreht
- **Stumpf+IR-Schweissung**
- **PP Pure grau**

Flansche finden Sie bitte unter Zubehör.

| Dimension | Code | Detail | Gewicht |
|-----------|----------------|------------------------|---------|
| 110 | 72.012.9110.11 | 110X10,0 SDR11 ISO S-5 | 0.43 |

| | Einheit | Nominale | Tol+ | Tol- |
|--------|---------|----------|------|------|
| da(OD) | mm | 110 | 1.00 | 0.00 |
| L | mm | 82 | 3.75 | 3.00 |
| L3 | mm | 38 | 1.50 | 0.00 |
| s | mm | 10 | 1.10 | 0.00 |
| d | mm | 100 | 3.00 | 0.00 |
| alph | [°] | 30 | 0.00 | 3.00 |
| d3 | mm | 125 | 0.00 | 4.50 |
| h | mm | 18 | 1.50 | 2.25 |
| d4 | mm | 158 | 0.00 | 1.50 |