

Fittings

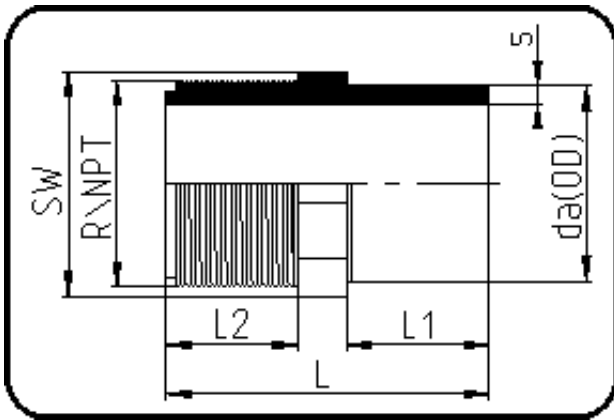

Code: 033.1

- Adapter Aussengewinde
- NPT-Gewinde
- formgespritzt
- **Stumpf+IR-Schweissung**
- **PP natur**

Dimension	Code	Detail	Gewicht
50	16.033.5051.11	50X1 1/2" SDR11 ISO S-5	0.06

	Einheit	Nominale	Tol+	Tol-
da(OD)	mm	50	0.50	0.00
L	mm	74	3.00	3.00
L1	mm	33	1.50	1.50
NPT	inch	1,5	0.00	0.00
nr	ril	1,77	0.00	0.00
SW	mm	55	2.25	2.25
L2	mm	29	1.50	1.50
s	mm	4,6	0.60	0.00
E	mm	10,67	0.00	0.00
K	mm	45,62	0.00	0.00