

Fittings

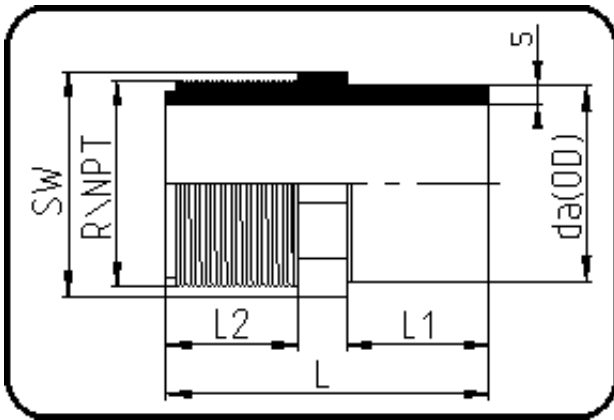

Code: 033

- Adapter Aussengewinde
- R-Gewinde
- formgespritzt
- **Stumpf+IR-Schweissung**
- **PP Pure grau**

Dimension	Code	Detail	Gewicht
40	72.033.4040.11	40X1 1/4" SDR11 ISO S-5	0.06

	Einheit	Nominale	Tol+	Tol-
da(OD)	mm	40	0.40	0.00
L	mm	66	3.00	3.00
L1	mm	29	1.50	1.50
SW	mm	46	2.25	2.25
L2	mm	26,5	1.50	1.50
s	mm	3,7	0.50	0.00
R	inch	1,25	0.00	0.00
E	mm	41,91	0.00	0.00
K	mm	38,95	0.00	0.00