

## Fittings

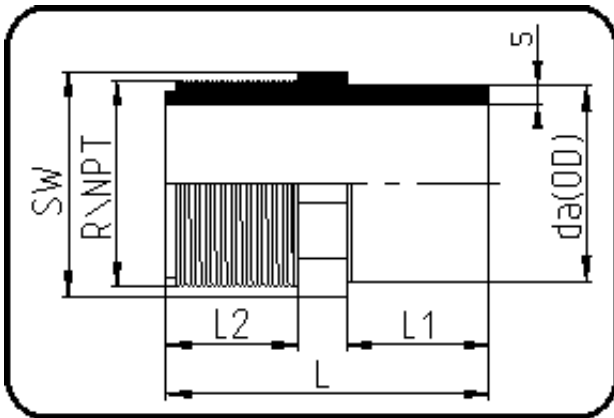

Code: 033.1

- Adapter Aussengewinde
- NPT-Gewinde
- formgespritzt
- **Stumpf+IR-Schweissung**
- **PP Pure grau**

Dimension	Code	Detail	Gewicht
63	72.033.6364.11	63X2" SDR11 ISO S-5	0.09

	Einheit	Nominale	Tol+	Tol-
da(OD)	mm	63	0.60	0.00
L	mm	80	3.00	3.00
L1	mm	35	1.50	1.50
NPT	inch	2	0.00	0.00
nr	ril	1,77	0.00	0.00
SW	mm	65	2.25	2.25
L2	mm	32,5	1.50	1.50
s	mm	5,8	0.70	0.00
E	mm	11,07	0.00	0.00
K	mm	57,63	0.00	0.00