

E-Schweissbare Fittings

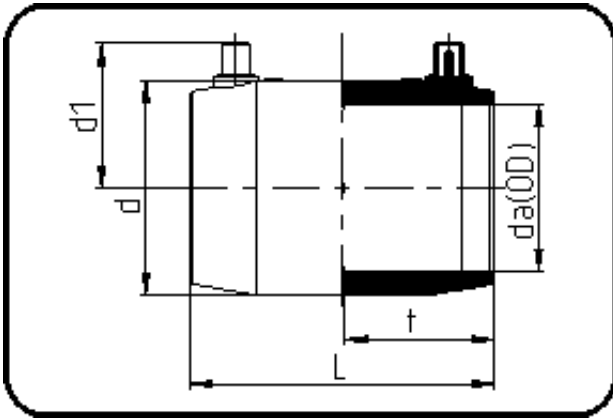

Code: 173

- E-Muffe
- MOP Wasser 16bar / Gas 10bar
- W/P-TW
- formgespritzt
- **Heizwendel-Schweissung**
- PE 100-RC schwarz

Dimension	Code	Detail	Gewicht
500	70.173.0500.11	500 SDR 17-11	25.17

	Einheit	Nominale	Tol+	Tol-
da(OD)	mm	500	0.00	0.00
L	mm	360	6.00	0.00
d	mm	604	1.50	1.50
d1	mm	289	3.00	3.00
t	mm	178,5	4.50	0.00