

## E-Schweissbare Fittings

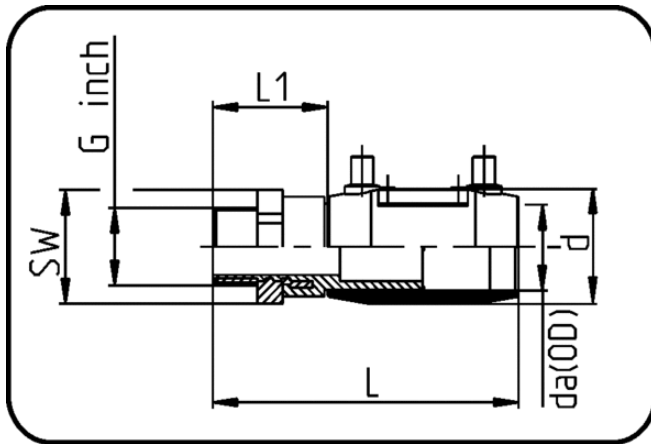

Code: 185

- E-Übergangsmuffe
- mit Messing-Aussengewinde
- W/P-TW
- formgespritzt
- Heizwendel-Schweissung
- PE 100-RC schwarz

Dimension	Code	Detail	da(OD) mm	L mm	L1 mm	d mm	SW mm	G inch	Gewicht
20 X 1/2	70.185.2020.11	20X1/2" SDR 11 PN16	20	120	45	30	32	0,5	0.14
25 X 3/4	70.185.2525.11	25X3/4" SDR 11 PN16	25	127	46	35	36	0,75	0.18
32 X 1/2	70.185.2032.11	32X1/2" SDR 11 PN16	32	132	43	42	41	0,5	0.26
32 X 3/4	70.185.2532.11	32X3/4" SDR 11 PN16	32	133	44	42	41	0,75	0.24
32 X 1	70.185.3232.11	32X1" SDR 11 PN16	32	138	49	42	41	1	0.24
32 X 1 1/4	70.185.4032.11	32X1 1/4" SDR 11 PN16	32	138	49	42	46	1,25	0.37
32 X 1 1/2	70.185.5032.11	32X1 1/2" SDR 11 PN16	32	140	51	42	55	1,5	0.55
40 X 1	70.185.3240.11	40X1" SDR 17-11 PN16	40	147	48	53	50	1	0.39
40 X 1 1/4	70.185.4040.11	40X1 1/4" SDR 17-11 PN16	40	151	52	53	50	1,25	0.37
40 X 1 1/2	70.185.5040.11	40X1 1/2" SDR 17-11 PN16	40	151	52	53	55	1,5	0.50
40 X 2	70.185.6340.11	40X2" SDR 17-11 PN16	40	155	56	53	65	2	0.85
50 X 1	70.185.3250.11	50X1" SDR 17-11 PN16	50	159	48	67	60	1	0.60
50 X 1 1/4	70.185.4050.11	50X1 1/4" SDR 17-11 PN16	50	162	51	67	60	1,25	0.57
50 X 1 1/2	70.185.5050.11	50X1 1/2" SDR 17-11 PN16	50	166	55	67	60	1,5	0.53
50 X 2	70.185.6350.11	50X2" SDR 17-11 PN16	50	168	57	67	65	2	0.83
63 X 1 1/4	70.185.4063.11	63X1 1/4" SDR 17-11 PN16	63	179	52	83	70	1,25	0.90
63 X 1 1/2	70.185.5063.11	63X1 1/2" SDR 17-11 PN16	63	183	56	83	70	1,5	0.83
63 X 2	70.185.6363.11	63X2" SDR 17-11 PN16	63	189	62	83	70	2	0.83