

E-Schweissbare Fittings

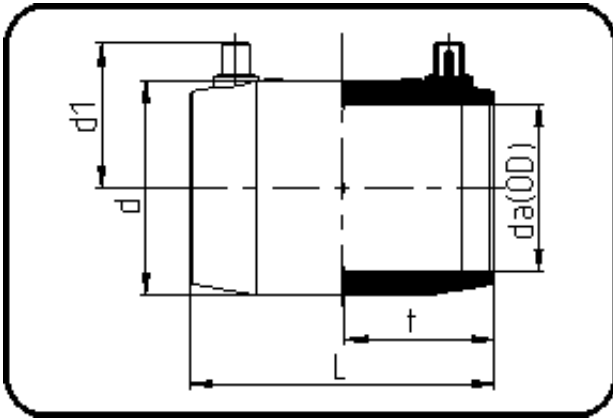

Code: 173

- E-Muffe
- MOP Wasser 25bar / Gas 10bar
- MOP Wasser ÖVGW 16bar W/P-TW
- formgespritzt
- **Heizwendel-Schweissung**
- **PE 100-RC schwarz**

| Dimension | Code | Detail | Gewicht |
|-----------|----------------|----------------|---------|
| 110 | 70.173.0110.11 | 110 SDR 17-7,4 | 0.71 |

| | Einheit | Nominale | Tol+ | Tol- |
|--------|---------|----------|------|------|
| da(OD) | mm | 110 | 0.00 | 0.00 |
| L | mm | 149 | 4.50 | 0.00 |
| d | mm | 136 | 1.50 | 1.50 |
| d1 | mm | 83 | 1.50 | 1.50 |
| t | mm | 73 | 3.00 | 0.00 |