

## E-Schweissbare Fittings

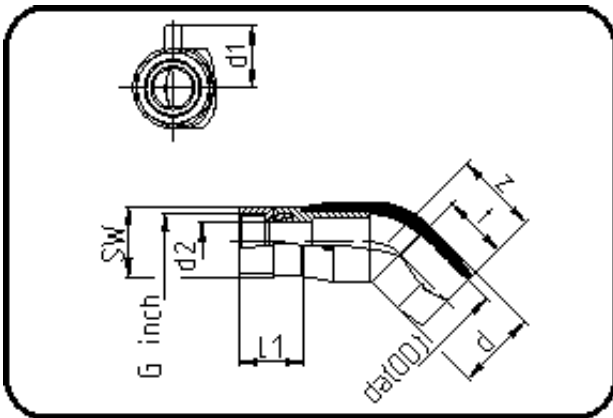

Code: 189

- E-Übergangswinkel 45°
- mit Messing-Innengewinde
- W/P-TW
- formgespritzt
- Heizwendel-Schweissung
- PE 100-RC schwarz

| Dimension | Code           | Detail            | Gewicht |
|-----------|----------------|-------------------|---------|
| 32 X 1    | 70.189.3232.11 | 32X1" SDR 11 PN16 | 0.27    |

|        | Einheit | Nominale | Tol+ | Tol- |
|--------|---------|----------|------|------|
| da(OD) | mm      | 32       | 0.00 | 0.00 |
| L1     | mm      | 44       | 1.50 | 1.50 |
| SW     | mm      | 41       | 0.00 | 0.00 |
| G      | inch    | 1        | 0.00 | 0.00 |
| d      | mm      | 42       | 0.75 | 0.75 |
| d1     | mm      | 40       | 1.50 | 1.50 |
| t      | mm      | 44       | 0.00 | 0.90 |
| E      | mm      | 33,25    | 0.00 | 0.00 |
| d2     | mm      | 21       | 0.00 | 0.00 |
| K      | mm      | 30,29    | 0.00 | 0.00 |
| z      | mm      | 56       | 2.25 | 2.25 |