

E-Schweissbare Fittings

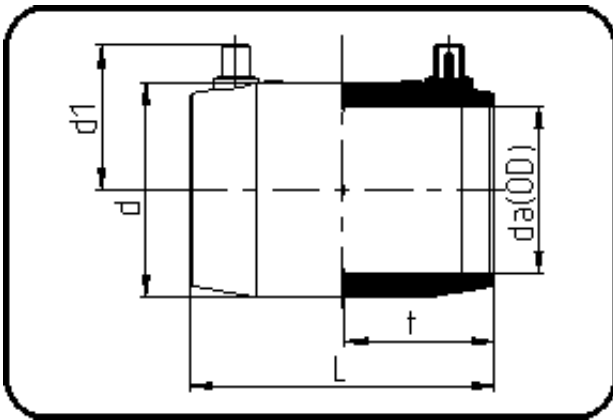

Code: 173

- E-Muffe
- MOP Wasser 16bar / Gas 10bar
- W/P-TW
- formgespritzt
- **Heizwendel-Schweissung**
- PE 100-RC schwarz

Dimension	Code	Detail	Gewicht
400	70.173.0400.11	400 SDR 26-11	15.34

	Einheit	Nominale	Tol+	Tol-
da(OD)	mm	400	0.00	0.00
L	mm	300	6.00	0.00
d	mm	491	1.50	1.50
d1	mm	240	3.00	3.00
t	mm	148,5	4.50	0.00