

Rohrbögen

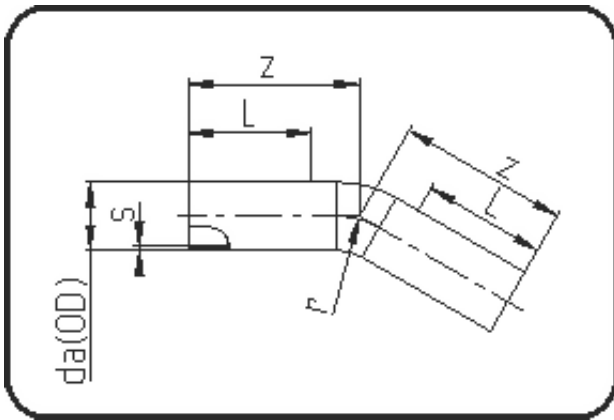

Code: 396

- Rohrbogen 30°
- Radius 1,5 x da
- aus Rohr geformt
- **Stumpf + E-Muffenschweissung**
- **PE 100-RC schwarz**

Dimension	Code	Detail	Gewicht
355	70.396.0355.11	355 SDR11 ISO S-5 16 bar	46.00

	Einheit	Nominale	Tol+	Tol-
da(OD)	mm	355	0.00	0.00
L	mm	450	0.00	0.00
r	mm	533	0.00	0.00
s	mm	32,2	0.00	0.00
z	mm	700	75.00	75.00