

E-Schweissbare Fittings

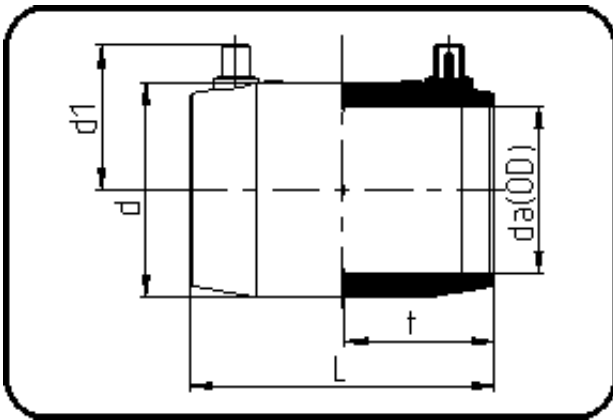

Code: 173

- E-Muffe
- MOP Wasser 10bar / Gas 6bar
- W/P-TW
- formgespritzt
- **Heizwendel-Schweissung**
- **PE 100-RC schwarz**

Dimension	Code	Detail	Gewicht
200	70.173.0200.17	200 SDR 26-17	2.02

	Einheit	Nominale	Tol+	Tol-
da(OD)	mm	200	0.00	0.00
L	mm	215,5	4.50	0.00
d	mm	234	1.50	1.50
d1	mm	127	1.50	1.50
t	mm	105	4.50	0.00