

## E-Schweissbare Fittings

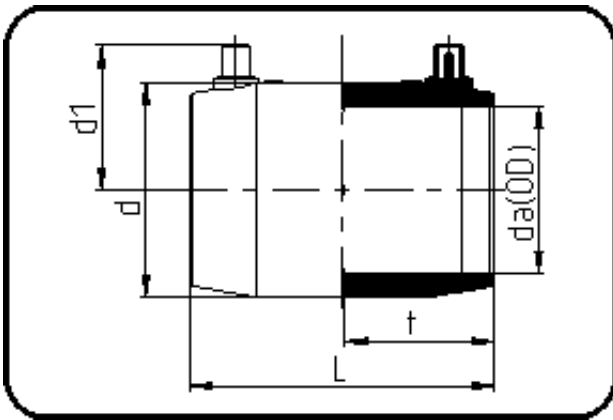

Code: 173

- E-Muffe
- MOP Wasser 25bar / Gas 10bar
- MOP Wasser ÖVGW 16bar W/P-TW
- formgespritzt
- **Heizwendel-Schweissung**
- **PE 100-RC schwarz**

Dimension	Code	Detail	Gewicht
63	70.173.0063.11	63 SDR 17-7,4	0.25

	Einheit	Nominale	Tol+	Tol-
da(OD)	mm	63	0.00	0.00
L	mm	124,5	4.50	0.00
d	mm	83	0.75	0.75
d1	mm	59	1.50	1.50
t	mm	62	1.50	0.00