

E-Schweissbare Fittings

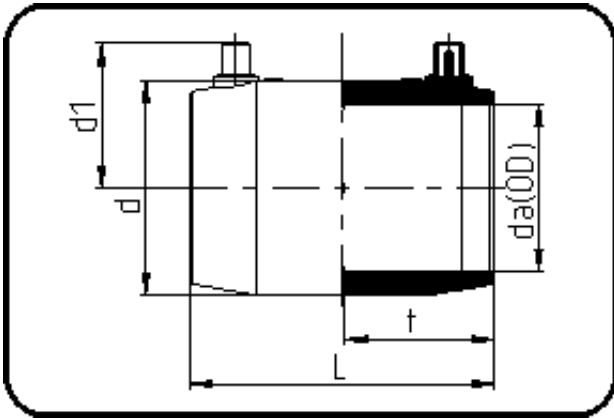

Code: 173

- E-Muffe
- MOP Wasser 10bar / Gas 6bar
- W/P-TW
- formgespritzt
- **Heizwendel-Schweissung**
- PE 100-RC schwarz

| Dimension | Code | Detail | Gewicht |
|-----------|----------------|---------------|---------|
| 250 | 70.173.0250.17 | 250 SDR 26-17 | 4.01 |

| | Einheit | Nominale | Tol+ | Tol- |
|--------|---------|----------|------|------|
| da(OD) | mm | 250 | 0.00 | 0.00 |
| L | mm | 240 | 6.00 | 0.00 |
| d | mm | 293 | 1.50 | 1.50 |
| d1 | mm | 152,5 | 1.50 | 1.50 |
| t | mm | 118 | 4.50 | 0.00 |