

## E-Schweissbare Fittings

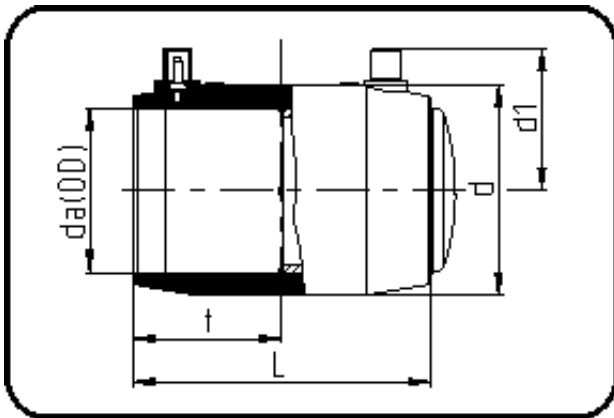

Code: 174

- E-Endkappe
- MOP Wasser 16bar / Gas 10bar
- W/P-TW
- formgespritzt
- **Heizwendel-Schweissung**
- PE 100-RC schwarz

| Dimension | Code           | Detail       | Gewicht |
|-----------|----------------|--------------|---------|
| 75        | 70.174.0075.11 | 75 SDR 17-11 | 0.50    |

|        | Einheit | Nominale | Tol+ | Tol- |
|--------|---------|----------|------|------|
| da(OD) | mm      | 75       | 0.00 | 0.00 |
| L      | mm      | 139,5    | 4.50 | 0.00 |
| d      | mm      | 97       | 0.75 | 0.75 |
| d1     | mm      | 65,5     | 1.50 | 1.50 |
| t      | mm      | 68,5     | 2.25 | 0.00 |