

## E-Schweissbare Fittings

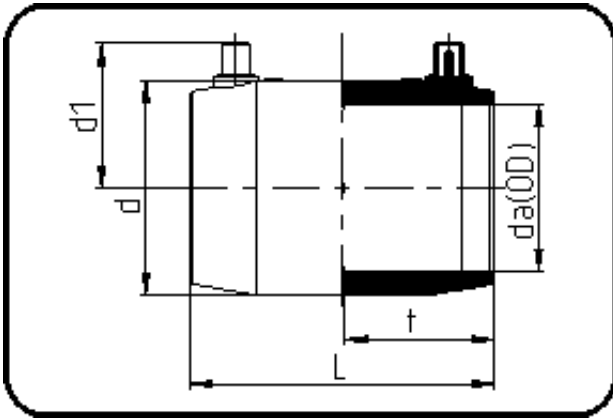

Code: 173

- E-Muffe
- MOP Wasser 10bar / Gas 6bar
- W/P-TW
- formgespritzt
- **Heizwendel-Schweissung**
- **PE 100-RC schwarz**

Dimension	Code	Detail	Gewicht
180	70.173.0180.17	180 SDR 26-17	1.62

	Einheit	Nominale	Tol+	Tol-
da(OD)	mm	180	0.00	0.00
L	mm	199	4.50	0.00
d	mm	212	1.00	1.00
d1	mm	117,5	1.00	1.00
t	mm	97	4.50	0.00