

## E-Schweissbare Fittings

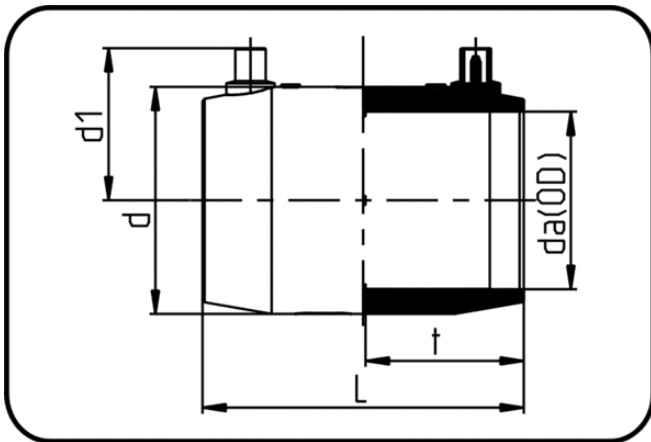

Code: 173

- E-Muffe
- MOP Wasser 10bar / Gas 6bar
- W/P-TW
- formgespritzt
- Heizwendel-Schweissung
- PE 100-RC schwarz

Dimension	Code	Detail	da(OD) mm	L mm	d mm	d1 mm	t mm	Gewicht
90	70.173.0090.17	90 SDR 26-17	90	138,5	109	74	67,5	0.36
110	70.173.0110.17	110 SDR 26-17	110	150,5	133	82	73,5	0.54
125	70.173.0125.17	125 SDR 26-17	125	170	149	92	83,5	0.83
140	70.173.0140.17	140 SDR 26-17	140	179	166	99	88	0.88
160	70.173.0160.17	160 SDR 26-17	160	179,5	188	107,5	88	1.08
180	70.173.0180.17	180 SDR 26-17	180	199	212	117,5	97	1.62
200	70.173.0200.17	200 SDR 26-17	200	215,5	234	127	105	2.02
225	70.173.0225.17	225 SDR 26-17	225	230	263	142	112	2.83
250	70.173.0250.17	250 SDR 26-17	250	240	293	152,5	118	4.01
280	70.173.0280.17	280 SDR 26-17	280	250	326	169	123,5	4.70
315	70.173.0315.17	315 SDR 33-17	315	259	366	185,5	128	6.36
355	70.173.0355.17	355 SDR 33-17	355	281	413	205,5	138,5	8.73
400	70.173.0400.17	400 SDR 33-17	400	299	466	235,5	148,5	11.90
450	70.173.0450.17	450 SDR 33-17	450	338	522	260	166,5	16.60
500	70.173.0500.17	500 SDR 33-17	500	360	579	286	177,5	21.20