

## E-Schweissbare Fittings

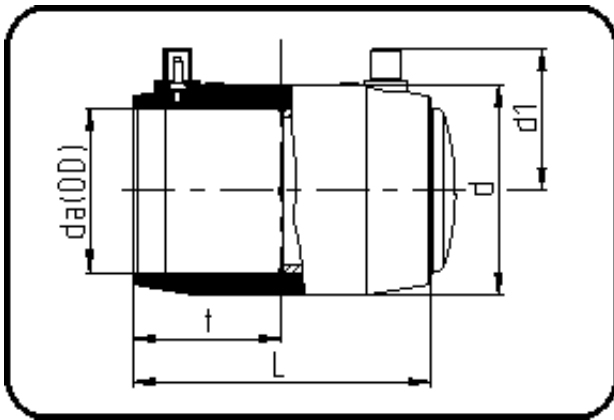

Code: 174

- E-Endkappe
- MOP Wasser 16bar / Gas 10bar
- W/P-TW
- formgespritzt
- Heizwendel-Schweissung
- PE 100-RC schwarz

Dimension	Code	Detail	Gewicht
280	70.174.0280.11	280 SDR 26-11	11.80

	Einheit	Nominale	Tol+	Tol-
da(OD)	mm	280	0.00	0.00
L	mm	249	6.00	0.00
d	mm	346	1.50	1.50
d1	mm	180	1.50	1.50
t	mm	121,5	4.50	0.00