

Rohrbögen

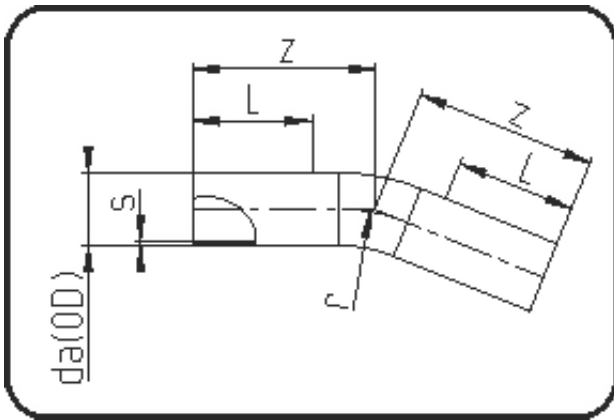

Code: 395

- Rohrbogen 22°
- Radius 1,5 x da
- aus Rohr geformt
- **Stumpf + E-Muffenschweissung**
- **PE 100-RC schwarz**

Dimension	Code	Detail	Gewicht
400	70.395.0400.17	400 SDR17 ISO S-8 10 bar	48.10

	Einheit	Nominale	Tol+	Tol-
da(OD)	mm	400	0.00	0.00
L	mm	550	0.00	0.00
r	mm	600	0.00	0.00
s	mm	23,7	0.00	0.00
z	mm	850	75.00	75.00