

## Rohrbögen

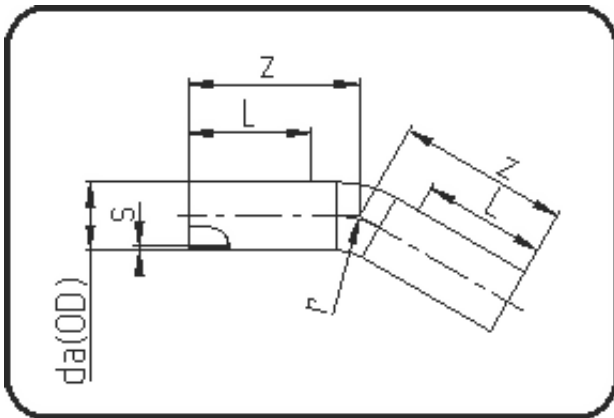

Code: 396

- Rohrbogen 30°
- Radius 1,5 x da
- aus Rohr geformt
- **Stumpf + E-Muffenschweissung**
- **PE 100-RC schwarz**

Dimension	Code	Detail	Gewicht
315	70.396.0315.11	315 SDR11 ISO S-5 16 bar	36.30

	Einheit	Nominale	Tol+	Tol-
da(OD)	mm	315	0.00	0.00
L	mm	450	0.00	0.00
r	mm	473	0.00	0.00
s	mm	28,6	0.00	0.00
z	mm	700	75.00	75.00