

## E-Schweissbare Fittings

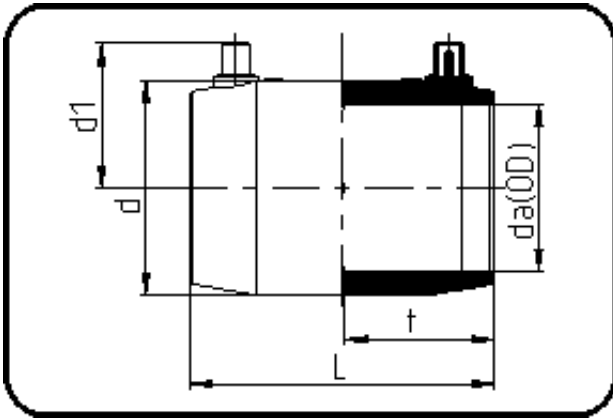

Code: 173

- E-Muffe
- MOP Wasser 10bar / Gas 6bar
- W/P-TW
- formgespritzt
- **Heizwendel-Schweissung**
- **PE 100-RC schwarz**

Dimension	Code	Detail	Gewicht
225	70.173.0225.17	225 SDR 26-17	2.83

	Einheit	Nominale	Tol+	Tol-
da(OD)	mm	225	0.00	0.00
L	mm	230	6.00	0.00
d	mm	263	1.50	1.50
d1	mm	142	1.50	1.50
t	mm	112	4.50	0.00