

E-Schweissbare Fittings

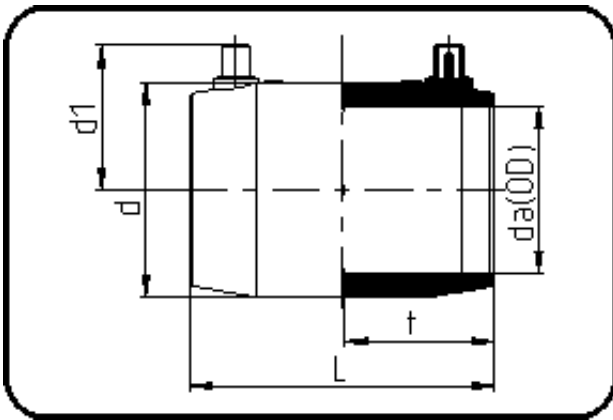

Code: 173

- E-Muffe
- MOP Wasser 25bar / Gas 10bar
- MOP Wasser ÖVGW 16bar W/P-TW
- formgespritzt
- **Heizwendel-Schweissung**
- **PE 100-RC schwarz**

Dimension	Code	Detail	Gewicht
50	70.173.0050.11	50 SDR 17-7,4	0.15

	Einheit	Nominale	Tol+	Tol-
da(OD)	mm	50	0.00	0.00
L	mm	108,5	4.50	0.00
d	mm	66,5	0.75	0.75
d1	mm	53	1.50	1.50
t	mm	54	1.50	0.00