

Kurzschenkelige Fittings

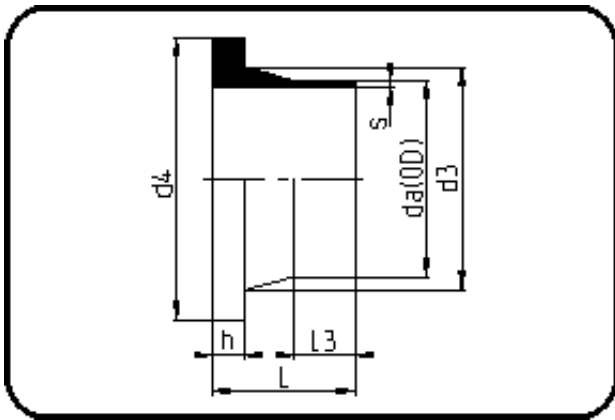

Code: 012.1

- **Vorschweissbund ANSI**
- kurze Schenkel
- formgespritzt
- **Stumpfschweissung**
- **PE 100-RC schwarz**

Flansche finden Sie bitte unter Zubehör.

| Dimension | Code | Detail | Gewicht |
|-----------|----------------|------------------------|---------|
| 355 | 70.012.1355.11 | 355X32,2 SDR11 ISO S-5 | 7.00 |

| | Einheit | Nominale | Tol+ | Tol- |
|--------|---------|----------|------|------|
| da(OD) | mm | 355 | 3.20 | 0.00 |
| L | mm | 150 | 6.00 | 0.00 |
| L3 | mm | 70 | 3.00 | 0.00 |
| s | mm | 32,2 | 3.40 | 0.00 |
| d3 | mm | 373 | 0.00 | 7.50 |
| h | mm | 40 | 1.50 | 0.00 |
| d4 | mm | 436 | 0.00 | 2.25 |
| da | inch | 14 | 0.00 | 0.00 |