

## Fittings

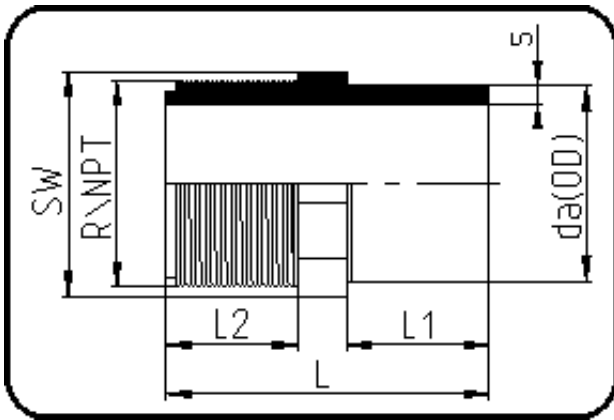

Code: 033.1

- Adapter Aussengewinde
- NPT-Gewinde
- formgespritzt
- **Stumpf+IR+HPF-Schweissung**
- PVDF natur

Dimension	Code	Detail	Gewicht
40	30.033.4041.21	40X1 1/4" SDR21 MOP 10 bar	0.07

	Einheit	Nominale	Tol+	Tol-
da(OD)	mm	40	0.40	0.00
L	mm	66	3.00	3.00
L1	mm	29	1.50	1.50
NPT	inch	1,25	0.00	0.00
nr	ril	1,77	0.00	0.00
SW	mm	46	2.25	2.25
L2	mm	27	1.50	1.50
s	mm	2,4	0.50	0.00
E	mm	10,67	0.00	0.00
K	mm	39,55	0.00	0.00